

# Loadbreak Apparatus Connectors

**COOPER** Power Systems

## 200 A 25 kV Class Insulated Protective Cap

Electrical Apparatus

500-39

### GENERAL

The Cooper Power System's RTE® Insulated Protective Cap is an accessory device designed to electrically insulate and mechanically seal loadbreak bushing interfaces. When mated to a loadbreak product and the drain wire is attached to ground, the Insulated Protective Cap provides a fully shielded, submersible insulating cover for energized bushings. The cap can be used for permanent or temporary installation on bushings, junctions, or feedthru devices that meet the requirements of ANSI/IEEE Standard 386.

### INSTALLATION

No special tools are required. A shotgun stick tool is used to place the protective cap on an exposed bushing interface. Refer to Installation Instruction Sheet S500-21-1 for details.

### PRODUCTION TESTS

Tests are conducted in accordance with ANSI/IEEE Standard 386.

- ac 60 Hz 1 Minute Withstand  
— 40 kV
- Minimum Corona Voltage Level  
— 19 kV

Tests are conducted in accordance with Cooper Power Systems requirements.

- Physical Inspection
- Periodic Dissection
- Periodic Fluoroscopic Analysis

**TABLE 1**  
Voltage Ratings and Characteristics

Description	kV
Standard Voltage Class	25
Maximum Rating Phase-to-Phase	26.3
Maximum Rating Phase-to-Ground	15.2
ac 60 Hz 1 Minute Withstand	40
dc 15 Minute Withstand	78
BIL and Full Wave Crest	125
Minimum Corona Voltage Level	19

Voltage ratings and characteristics are in accordance with ANSI/IEEE Standard 386.



**Figure 1.**  
Insulated Protective Cap electrically insulates and mechanically seals load-break bushing interfaces.

### ORDERING INFORMATION

To order the 25 kV Class Insulated Protective Cap Kit, refer to Table 2.

**TABLE 2**  
Insulated Protective Cap Kit

Description	Catalog Number
Protective Cap	LPC 225

Each kit contains:

- Protective Cap stranded copper ground wire
- Silicone Lubricant
- Installation Instruction Sheet

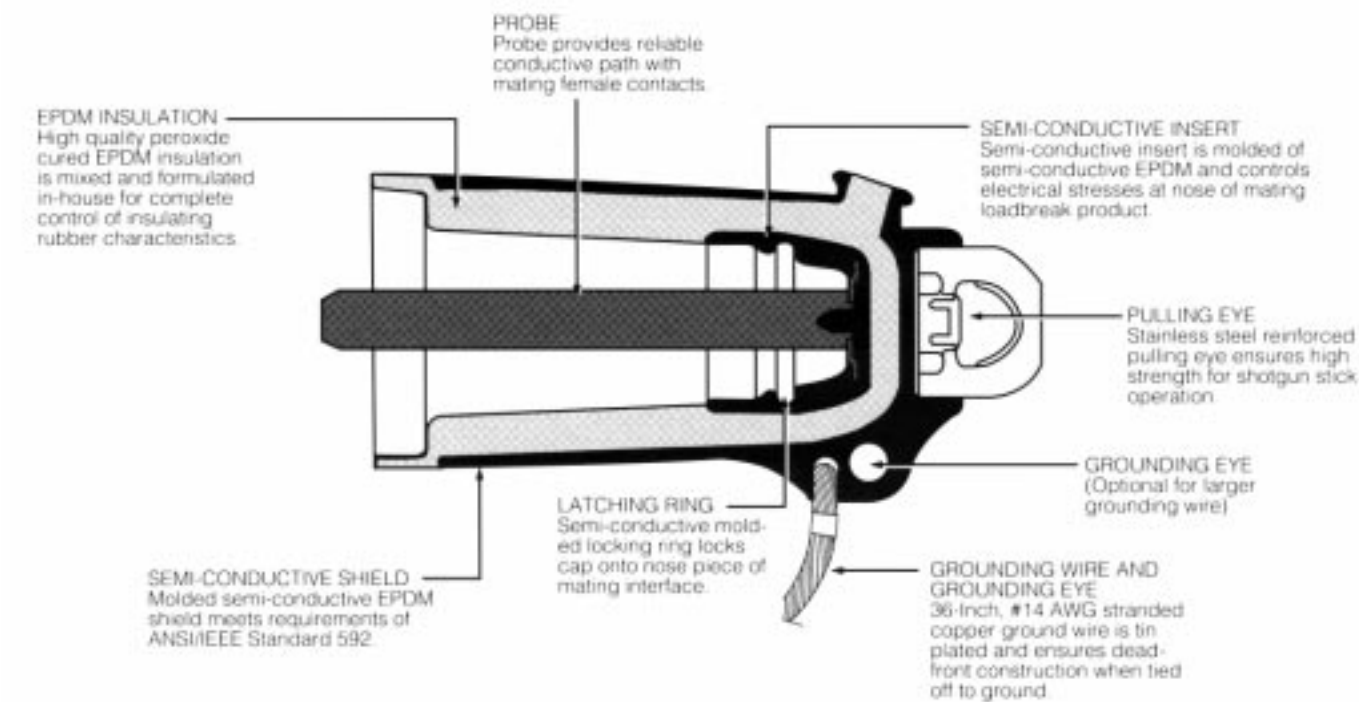

**Figure 2.**  
Illustration shows construction of insulated protective cap.

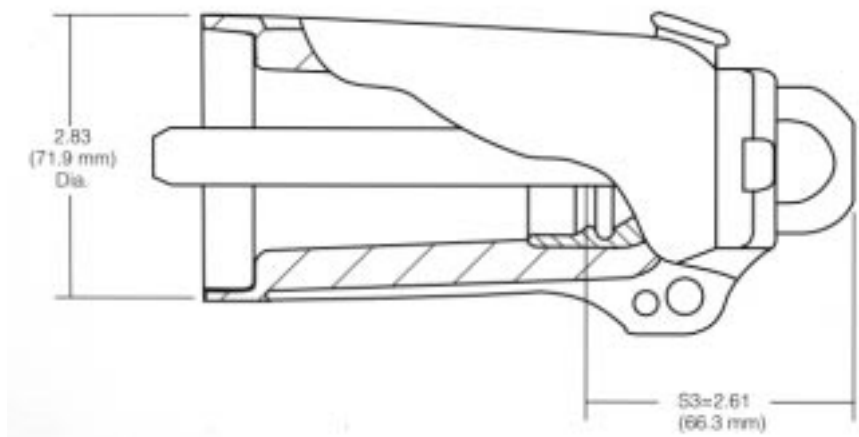

**Figure 3.**  
Insulated Protective Cap profile and stacking dimensions.